



# UNITILE CALCIUM SULPHATE PANEL

EMBARK ON GREEN  
WORKSPACE TRANSFORMATIONS



 **30**  
**Years**  
\_\_\_\_\_ of  
leadership  
\_\_\_\_\_ and legacy

 **100** mn  
**sq. ft.**  
\_\_\_\_\_ of  
workspaces  
\_\_\_\_\_ transformed

 **15** mn  
**sq. ft.**  
\_\_\_\_\_ annual  
production  
\_\_\_\_\_ capacity

**08**  
**Offices**  
across  
India \_\_\_\_\_  

 **15k+**  
**Clients**  
\_\_\_\_\_ across  
the globe

 **500+**  
**Unitilers**  
growing with  
40+ partners  
\_\_\_\_\_

# CERTIFICATIONS AND COMPLIANCE



World-class  
quality



Environmental  
consciousness



Health  
and safety  
measures



Fire  
certification  
– Thomas  
Belrite UK



Acoustics  
– ARAI



Indian  
Green  
Building  
Council



Singapore  
Green  
Building  
Council  
(SGBC)



Excellence  
guaranteed  
with third  
party tested  
at TÜV SÜD  
PSB,  
Singapore



Certified  
by  
Bureau  
Veritas,  
France

# FEATURING UNITILE CALCIUM SULPHATE PANEL

Environmentally friendly panels for intelligent spaces

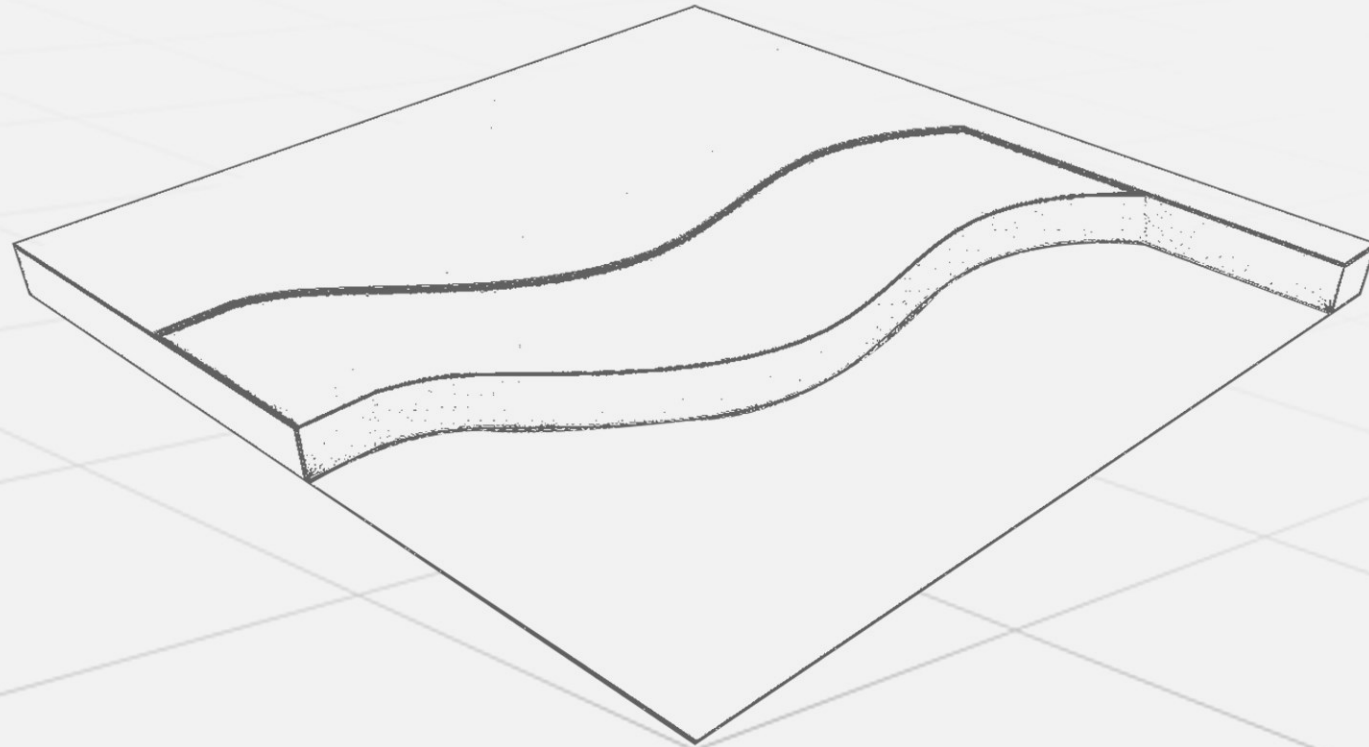

Made from calcium sulphate core, high-density of of natural gypsum. The edges of the panel are protected with a PVC edge band.

**Dimensions:** 600mm x 600mm

**Panel Thickness:** 28mm | 30mm | 32mm | 34mm

## SYSTEM SELECTION GUIDE

Structural performance as per BSEN 12825	34 mm
Concentrated Load	625 Kgs (6.12 kN)
Ultimate Concentrated Load	1250 Kgs / 12.25 kN
Uniformly Distributed Load (As per PSA MOB PF 2 PS/ CISCA)	1875 Kgs / m <sup>2</sup>
Stringer Load	102 Kgs (225 lbf)

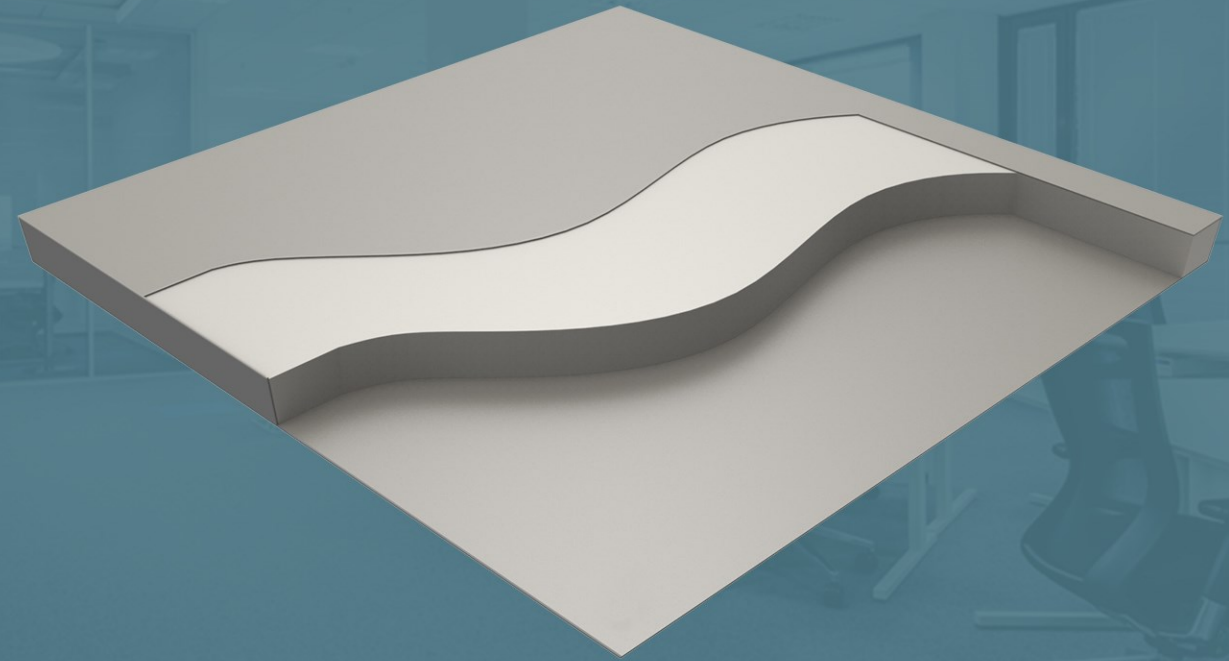

# TOP AND BOTTOM FINISHES

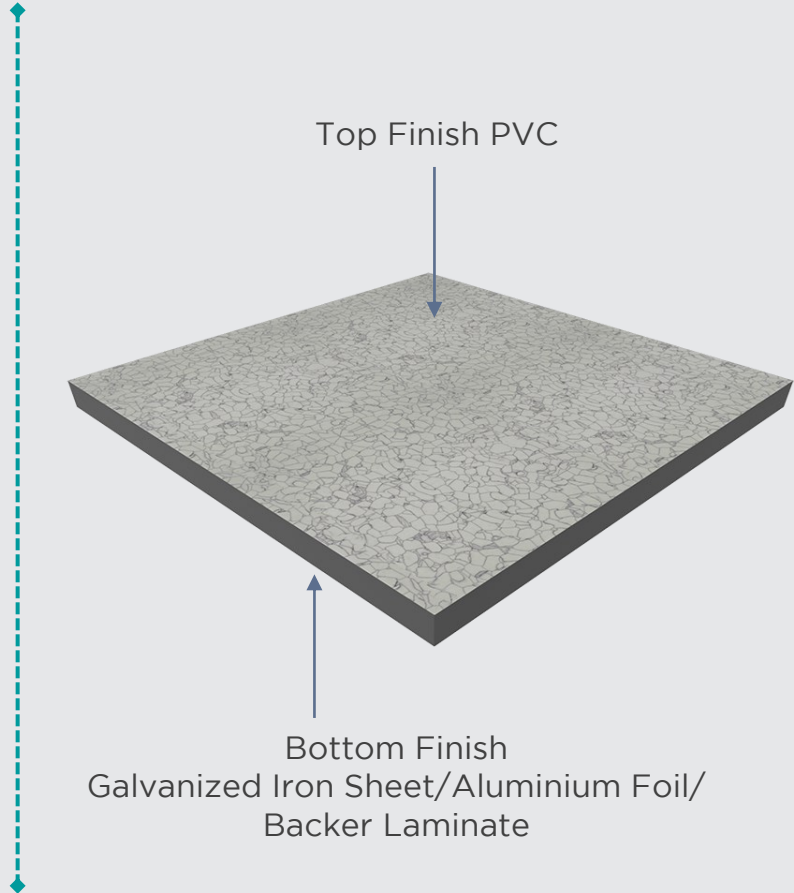
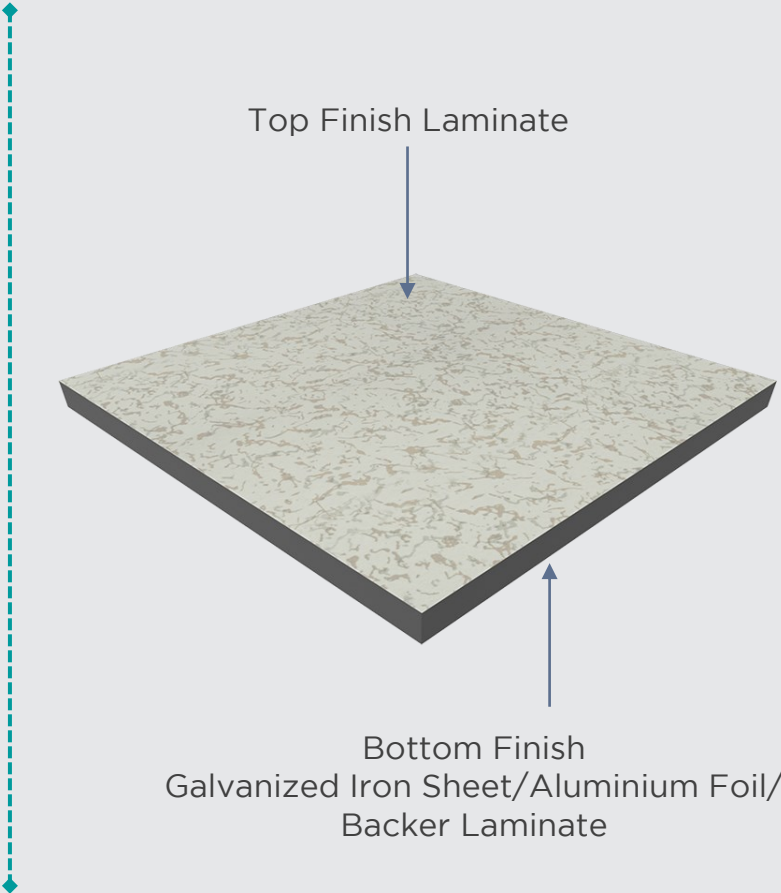
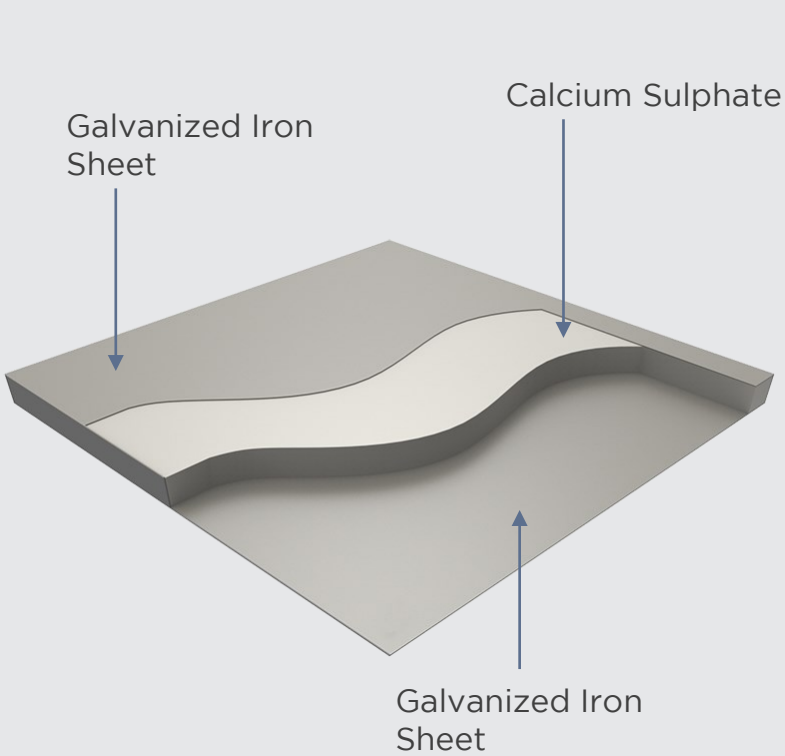

# AVAILABLE EDGE BAND

Regular PVC  
Edge Band

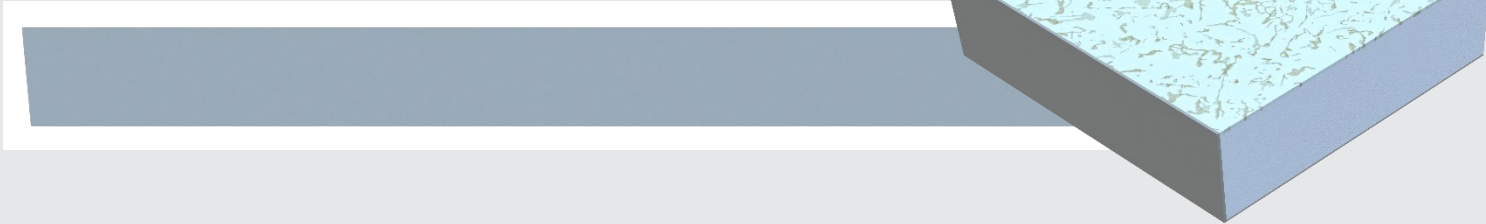

Profile PVC  
Edge Band



Aluminium  
Edge Band

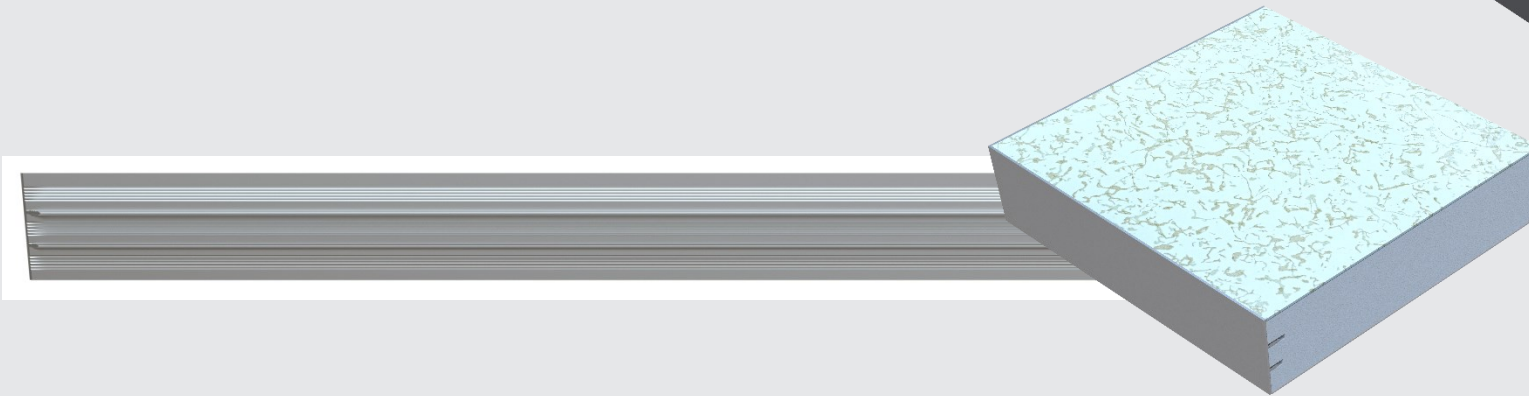

# FEATURES ALUMINIUM EDGE BAND



Excellent bonding to the panel with 100% solid aluminum edge

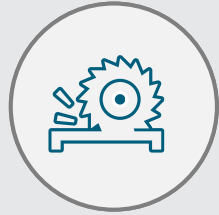

No debonding during cutting of field cut panels on site



Improves resistance to impact load during and after the construction program



Ensures conductivity 100%



Maximum resistance to damage by rolling load due to fully metal edges



Ensures easy and frequent removal without damaging the edges of the panel



It compliments the sturdy panel locking system provided on the understructure



Fire resistant or high level of fire



Protects peripheral chipping of the laminate as the impact is taken by the Aluminum edge band



Corrosion resistant



Aesthetically appealing to end user





# DESIGNED FOR NEW-AGE WORKSPACES

A better and conscious choice.

# OPEN OFFICE

## ACCESS FLOOR COMPONENTS

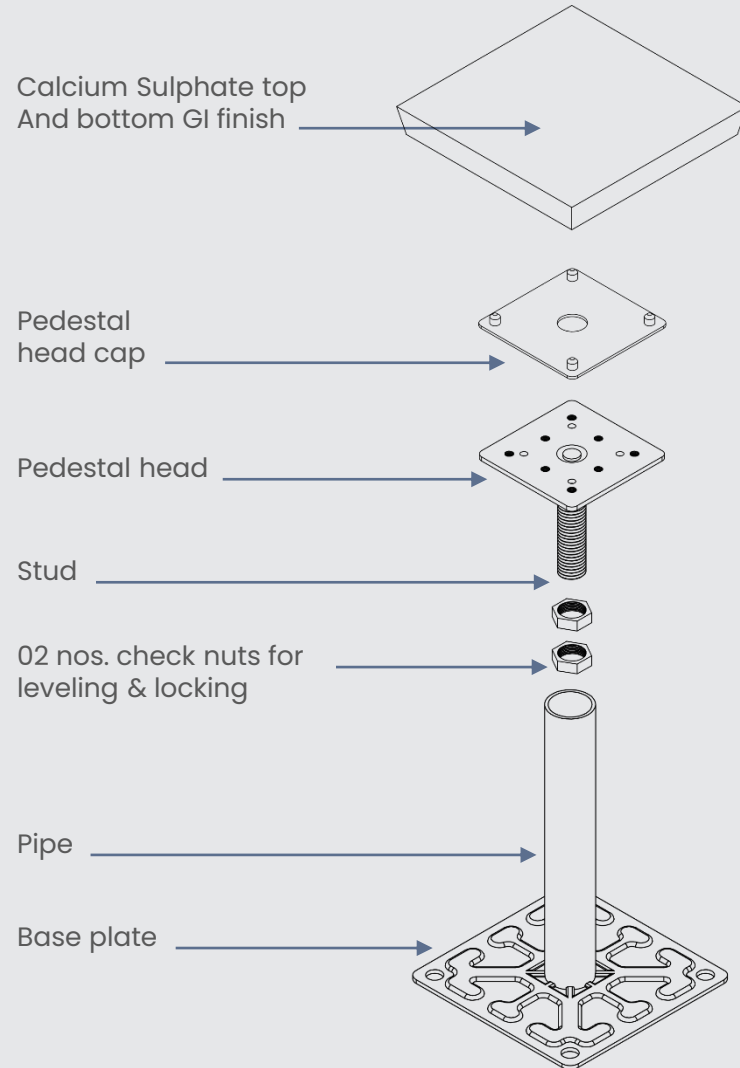

## GRAVITY LAY SYSTEM

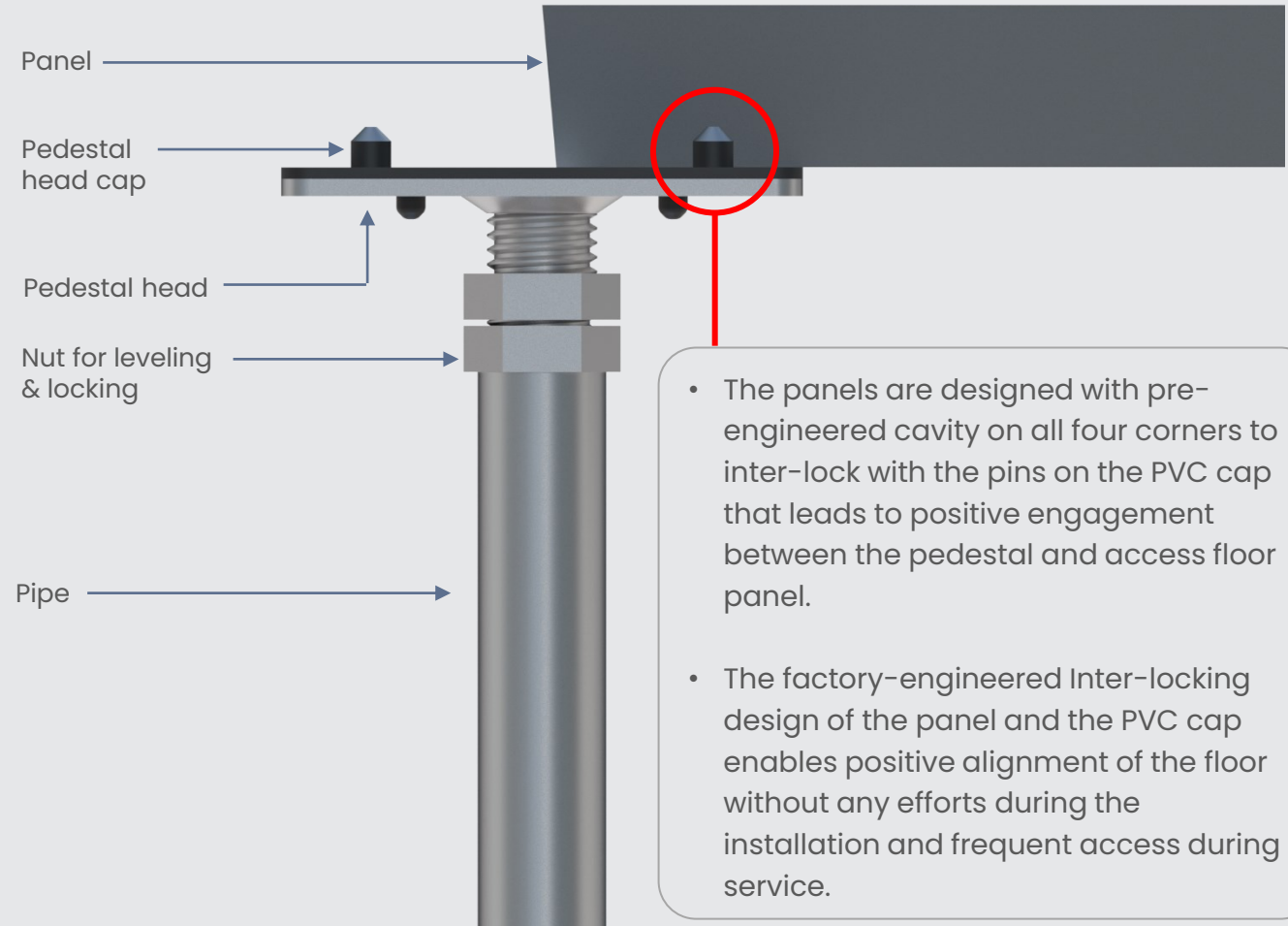

# A FUTURE-PROOF DATA CENTER

that has the flexibility to remain at the technological  
forefront

# CRITICAL ROOM, DATA CENTER & CONTROL ROOM

## ACCESS FLOOR COMPONENTS

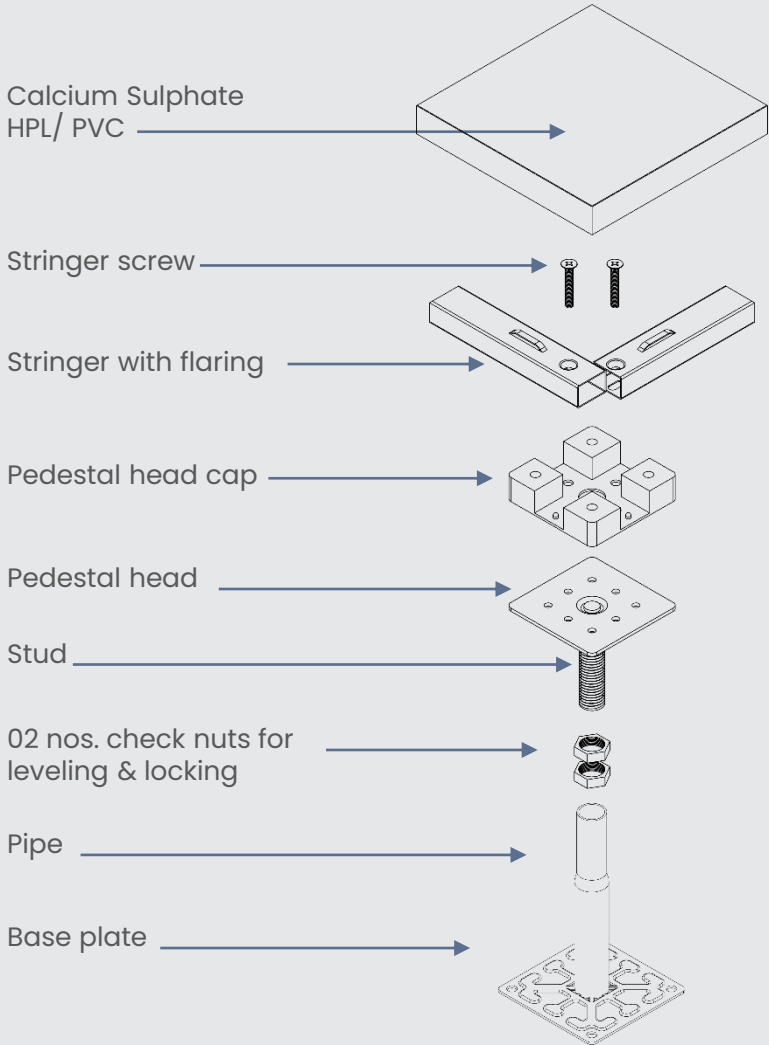

## EDGE SUPPORT RIGID GRID (ESRG) SYSTEM

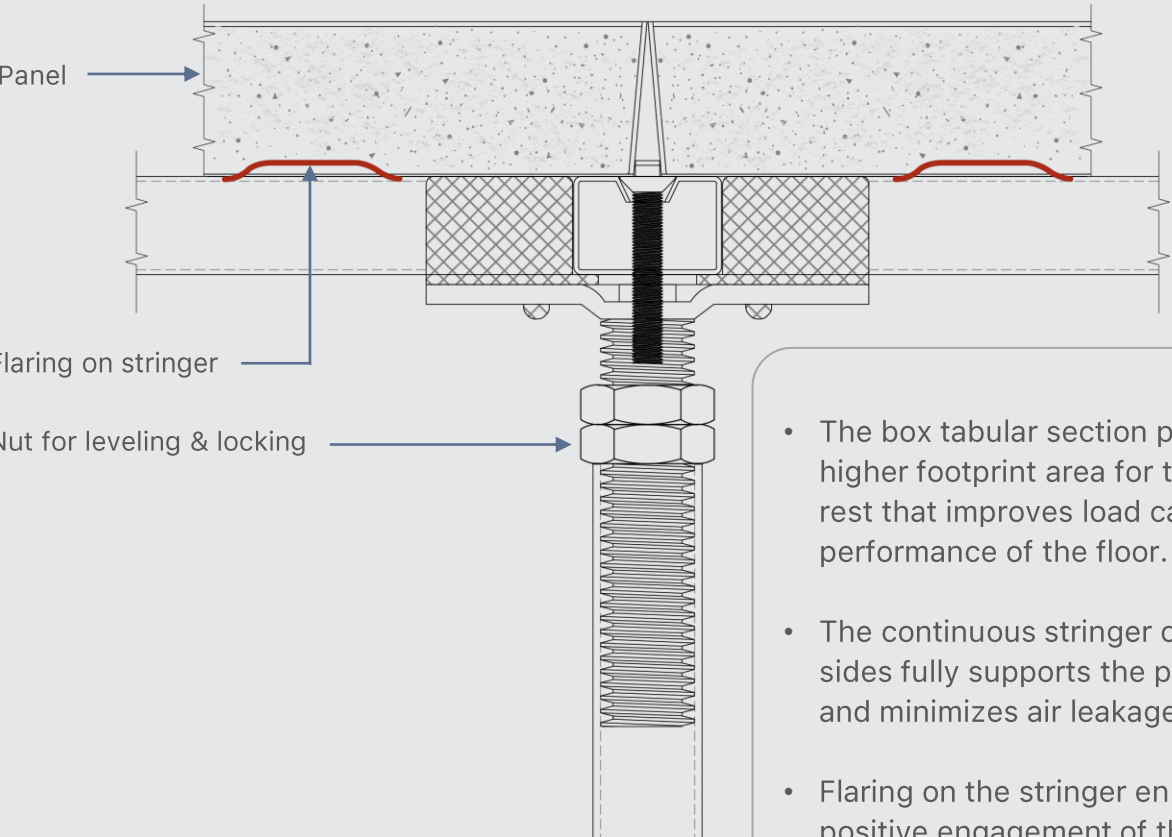

- The box tabular section provides a higher footprint area for the panel to rest that improves load carrying performance of the floor.
- The continuous stringer on both sides fully supports the panel edges and minimizes air leakage.
- Flaring on the stringer enhances positive engagement of the access floor panel

# BENEFITS AND ADVANTAGES



Excellent acoustic properties  
and dissipates electrical  
charges



Excellent fire resistance  
properties tested as per Class  
O and Class 1 standards

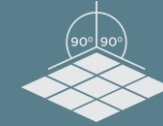

Precision in floor levels and  
positive alignment with the  
understructure



High strength  
to weight performance

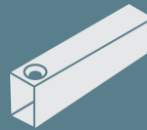

Unique  
In-built stringer design



The calcium sulphate core of the  
panels is recyclable using an  
appropriate recycling method



# OTHER APPLICATIONS

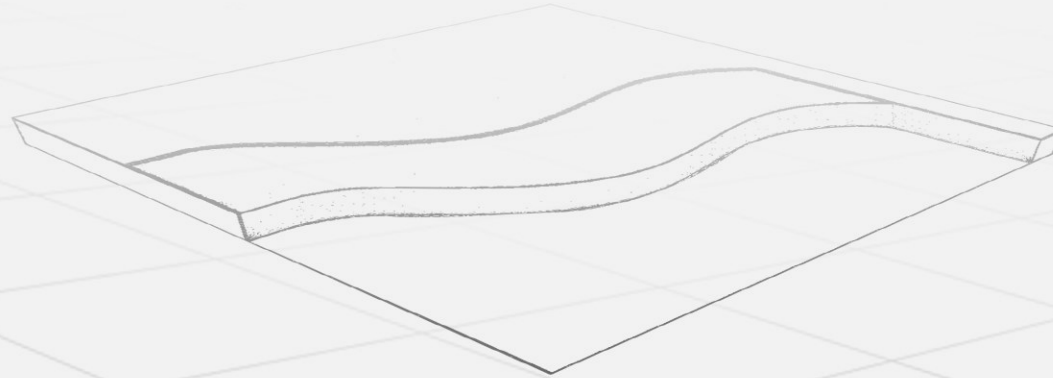

# OPEN OFFICES



# DATA CENTERS

- ◇ Communication Rooms
- ◇ Server Rooms
- ◇ Labs
- ◇ Process Interface Buildings (PIB)
- ◇ Rack Rooms
- ◇ Switch Rooms



# EDUCATIONAL SPACES

- ◇ Classrooms
- ◇ Auditoriums
- ◇ Libraries
- ◇ Training Rooms



# CONTROL ROOMS

- ◇ Network Operations Center (NOC)
- ◇ Supervisory Control and Data Acquisition (SCADA)



# CASINOS

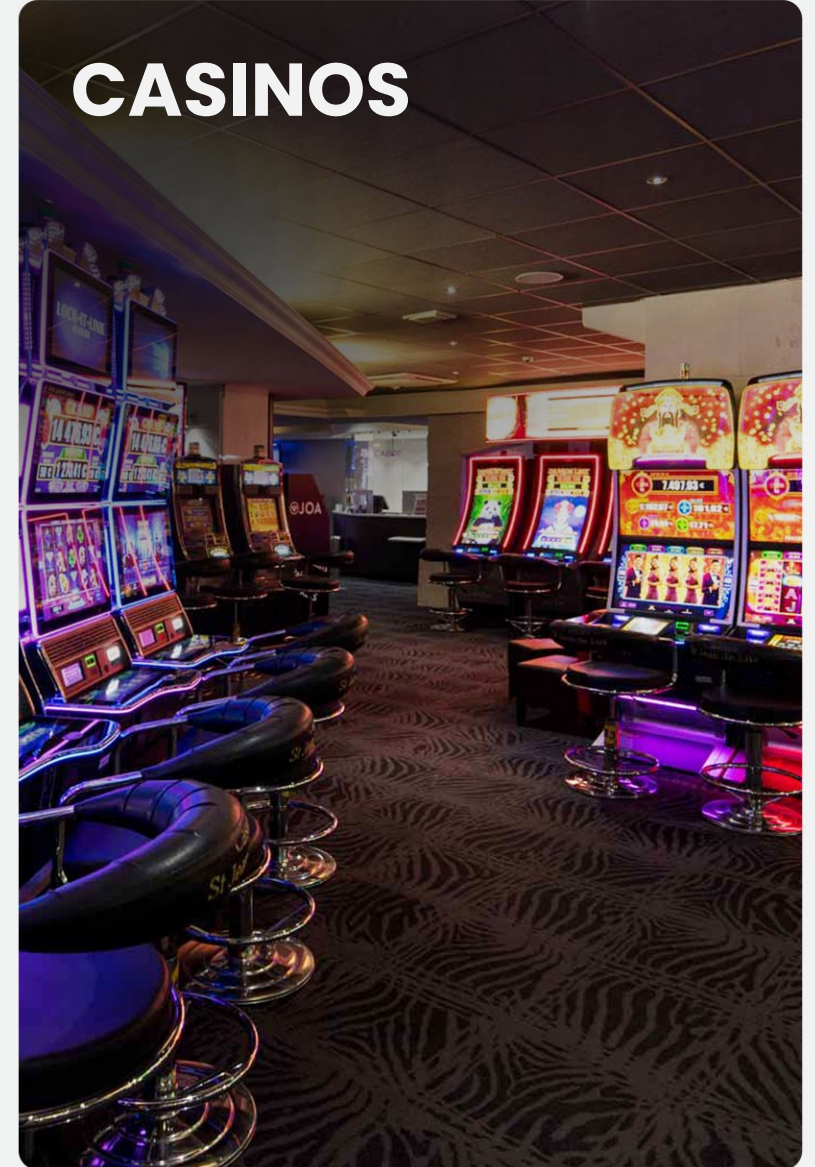





# KEY PROJECTS

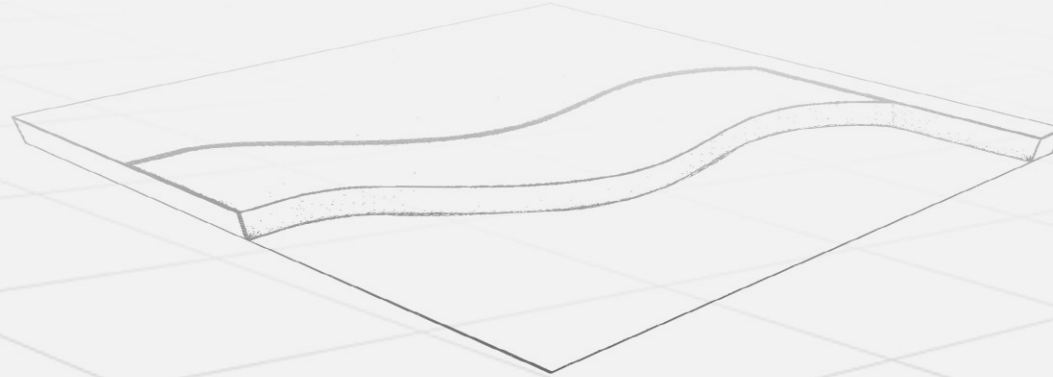

# PROJECTS EXECUTED WITH UNITILE CALCIUM SULPHATE PANEL (UCS)

\*Areas mentioned in sq. ft.



Mumbai, Nagpur  
& Hyderabad  
**14,36,000**



Navi Mumbai  
& Mumbai  
**5,38,555**



Navi Mumbai  
**2,36,248**



Navi Mumbai  
**1,31,988**



Bengaluru, Pune  
Noida & Chennai  
**1,10,214**



Chennai  
**64,595**



Delhi & Gujrat  
**21,265**



Ahmedabad &  
Hyderabad  
**16,643**

**AIR  
FORCE  
STATION**

Lucknow  
**11,291**



Jabalpur  
& Noida  
**5,763**



New Delhi  
**4,801**

**PRINTLINK  
OCAC EAST**

Odisha  
**3,229**

# PROJECTS EXECUTED WITH UNITILE CALCIUM SULPHATE PANEL (UCS)

\*Areas mentioned in sq. ft.



IndianOil

Cochin  
**2,806**



TELANGANA FIBER GRID

Hyderabad  
**2,700**



Mumbai  
**2,680**

**BLOOM  
DÉCOR  
ENTERPRISE**

Bharuch  
**2,248**



Chandigadh  
**1,722**



Mumbai  
**1,292**



Odisha  
**1,112**



Kanpur  
**431**



Bhopal  
**11,625**

PYROTECH



beyond the obvious®

Udaipur  
**6,118**



# KEY CLIENTS

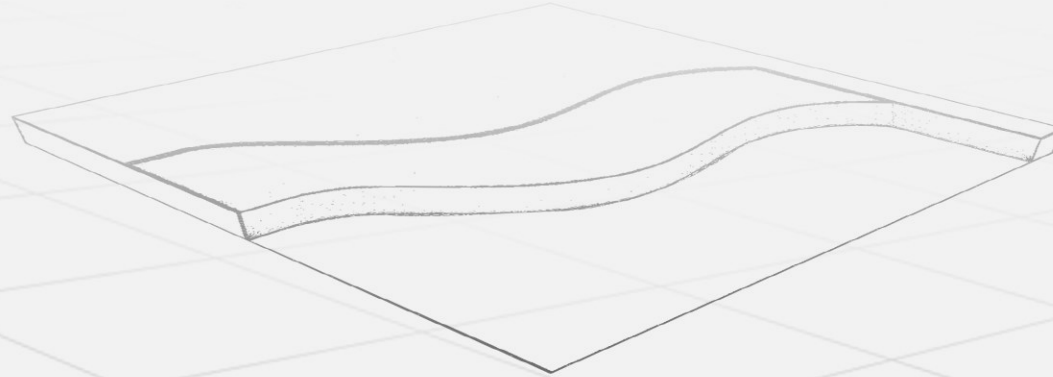

# KEY CLIENTS



# KEY CLIENTS



# OUR PRESENCE



## INDIA

Ahmedabad | Ankleshwar | Aurangabad | Bareilly | Bengaluru | Chandigarh | Chennai | Cuttack | Goa | Gurugram | Guwahati | Hyderabad | Indore | Jaipur | Kanpur | Kolkata | Lucknow | Mumbai | Nagpur | New Delhi | Pune | Raipur | Thane | Vadodara | Thiruvananthapuram | Cochin

## INTERNATIONAL

Azerbaijan | Bahrain | Bangladesh | Egypt | Hong Kong | Indonesia | Kenya | Nepal | Oman | Philippines | Qatar | Saudi Arabia | Singapore | Sri Lanka | Tanzania | Turkey | UAE | Vietnam | Maldives | Nigeria | Bhutan | South Africa